



Features

- ▶▶ Adjustable cushioning at both ends
- ▶▶ Wide varieties of mounting
- ▶▶ Low Friction
- ▶▶ Long Life

Technical Specification

Bore Die	16	20	25
Stroke	10, 20, 50, 80, 100, 125, 160, 175, 200, 250, 300		
Port Size	M5	1/8"	
Type	Double Acting		
Pressure	0.5 to 9 Kg		
Operating Speed	50 ~ 500 (mm / sec)		
Ambient Temperature	-10 °C to 70 °C		
Air	Air		

Basic Cylinder Dimension for AX502 Ø16 & Ø20

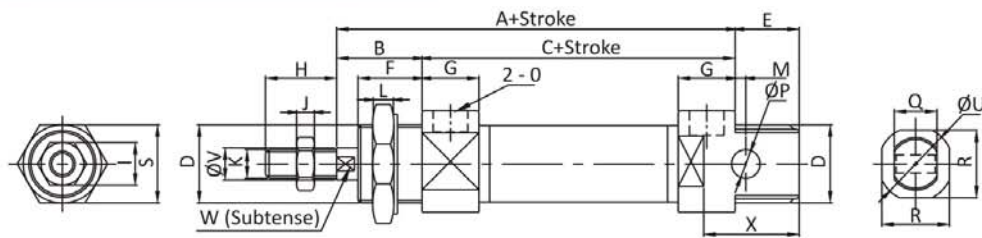

Basic Cylinder Dimension for AX502 Ø25

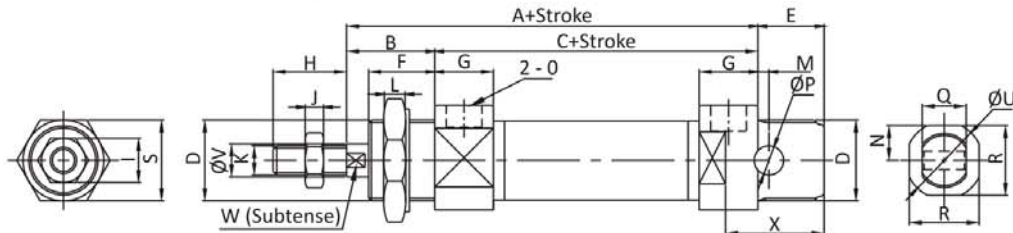

Bore die	A	B	C	D	E	F	G	H	I	J	K	O	L	M	N	P	Q	R	S	U	V	W	X
16	79	22	57	M16X1.5	16	17	12	16	10	4	M6	M5	6	5	---	6	12	19	22	21	6	---	23
20	92	24	68	M22X1.5	18	18	16	20	13	5	M8	G1/8"	8	3	15	8	16	27	27	30	8	7	27
25	96	27	68	M22X1.5	20	20	16	22	17	6	M10X1.25	G1/8"	8	8	15	8	16	27	27	30	10	9	---

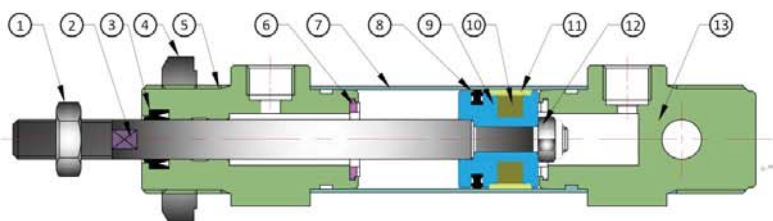

No.	Item Name	Material
1	Hexagon Nut	EN - 8 Hardchrome Plated
2	Piston Ring	EN - 8 Hardchrome Plated
3	Dust Sealing	NBR
4	Hexagon Nut	EN - 8 Hardchrome Plated
5	Front Cover	Aluminum
6	Crashworthy Washer	P. U.
7	Tube	SUS 304
8	C - Sealing	NBR
9	Piston	Aluminum
10	Magnet	Plastic Cement
11	Guard Seals	Teflon
12	Hexagon Nut	EN - 8 Hardchrome Plated
13	Read Cover	Aluminum